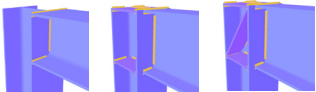
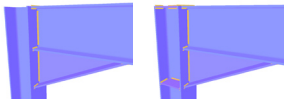
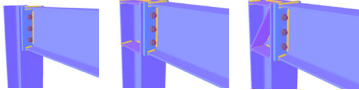
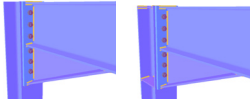
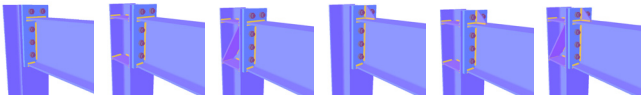
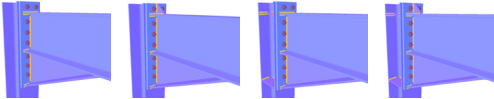
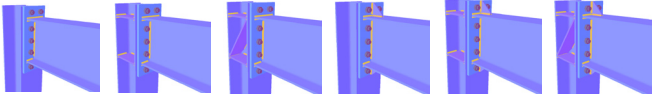
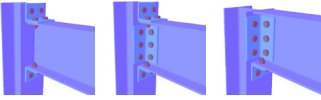
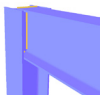
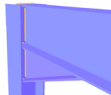
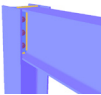
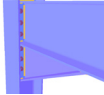
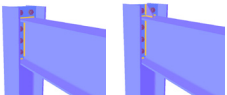
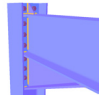
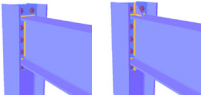
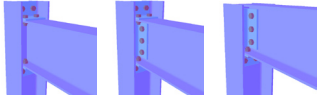

PowerConnect

Overzicht van types momentverbindingen

MOMENTVERBINDINGEN	DWARSKRACHTVERBINDINGEN	BUISVERBINDINGEN
BALK – KOLOMFLENS		
Gelast	Gelast met kniestuk	
		
Geboute eindplaat	Geboute eindplaat met kniestuk	
<i>standaard eindplaat</i>	<i>standaard eindplaat</i>	
		
<i>naar boven verlengde eindplaat</i>	<i>naar boven verlengde eindplaat</i>	
		
<i>naar boven en onder verlengde eindplaat</i>	<i>geboute hoekijzers</i>	
		
BALK – KOLOMLIJF		
Gelast	Gelast met kniestuk	
		
Geboute eindplaat	Geboute eindplaat met kniestuk	
<i>standaard eindplaat</i>	<i>standaard eindplaat</i>	
		
<i>naar boven verlengde eindplaat</i>	<i>naar boven verlengde eindplaat</i>	
		
<i>naar boven en onder verlengde eindplaat</i>	<i>geboute hoekijzers (op balkflenzen en/of balklijf)</i>	
		

BALK – KOLOMFLENS – BALK

Gelast

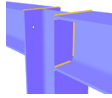

Geboute eindplaat

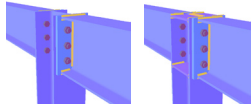
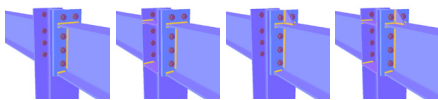
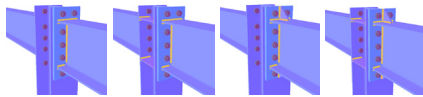
standaard eindplaat*naar boven verlengde eindplaat**naar boven en onder verlengde eindplaat*

Gelast met kniestuk

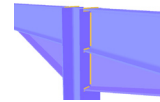

Geboute eindplaat met kniestuk

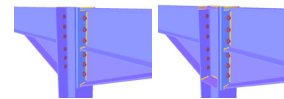
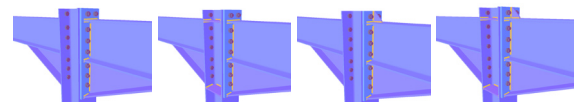
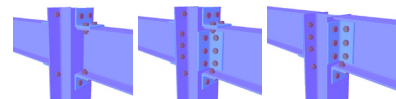
standaard eindplaat*naar boven verlengde eindplaat**geboute hoekijzers (op balkflenzen en/of balklijf)***BALK – BALK**

Gelast



Geboute eindplaat

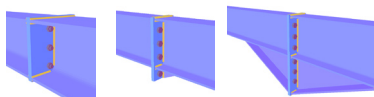

Geboute hoekijzers

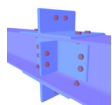

Geboute flens- en lijfplaten

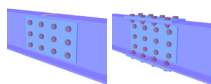
**KOLOMVOET**

Standaard voetplaat

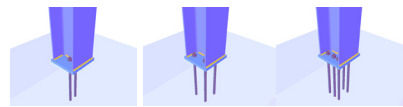

Verlengde voetplaat (1-zijdig)



Verlengde voetplaat (2-zijdig, elk 2 verankeringen)

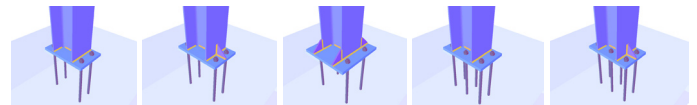

Verlengde voetplaat (2-zijdig, elk 3 verankeringen)

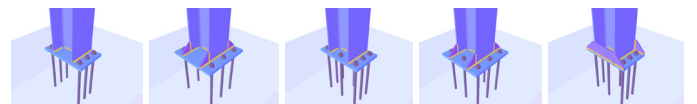

Voor meer informatie over PowerConnect, contacteer:

PowerConnect is een product van BuildSoft NV

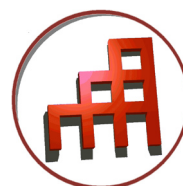

Hundelgemsesteenweg 244/1

B-9820 Merelbeke, België

☎ +32 (0)9 252 66 28 (B)

☎ +31 (0)316 332 640 (NL)

✉ +32 (0)9 252 66 29

✉ info@buildsoft.eu

www.BuildSoft.eu